

EURO-SEEDER T90 CE SKID



EURO-SEEDER T90 CE SKID

PRODUCT DESCRIPTION
FINN - the inventor of the Hydroseeder - is the world leader for over 80 years now in manufacturing these specialized machines that provide those Businesses anxious to intervene in the hydroseeding and hydromulching sector with power, efficiency and professionalism with the right equipment.

In order to choose the machine that's right for you and to learn more about this fascinating business, please visit the 'European Hydroseeding Guide' (currently only available in French) on our site www.euro-tec.fr

SPECIFICATIONS & PERFORMANCE

| | |
|---------------------------|--|
| Tank Capacity | 3 560 litre |
| Engine | Yanmar 3TNV88C-DYEM, 35.1hp (26.2kw), 1.6 Litre, 3 cylindres, liquid cooled, Diesel TIER IV-F |
| Mixing system | Mechanical Agitation with paddles, hydraulically powered, reversible, variable speed |
| Pump | FINN Centrifugal pump, 4" x 2" (10 cm x 5 cm), 170 GPM@100 psi (646 lpm @ 7 kg/cm ²), adjustable |
| Weight | 1 880 Kg empty / 6 000 Kg loaded |
| Dimensions | 335 cm length, 208 cm width, 259 cm height |
| Operator Platform | Operator platform equipped with an ergonomic boom/canon |
| Available Options | - Hydraulic hose reel with 60 lm 1 ¼ " hose - RAL paint to match your company colour |
| Spraying Distance | 55 metres from canon |
| Tank empty time | 6 minutes |
| Mixing capacity | 1 130 Kg granular (fertilizer) / 180 Kg Fibre Material (Mulch) |
| Daily Production Capacity | 20 000 m ² Hydroseeding / 5 500 m ² Hydromulching |

TECHNICAL ASSISTANCE / AFTER SALES SERVICE

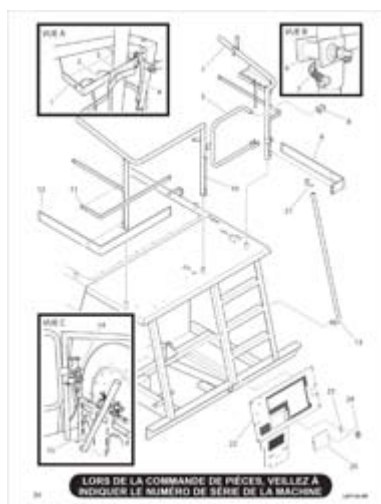

The User Manual with its exploded machine and parts view allows for optimum and quick reaction whenever needed, making use of an important spare part stock FINN Europe based in the Lyon (France) area. A technician on the hot-line can thus identify the issue, send spare parts or decide on eventual on-site support and repair.

CE COMPLIANCE



Euro-Tec

17, rue Hector Berlioz
69100 Villeurbanne - France
E-mail : euro-tec@euro-tec.fr
Tél. +33 (0)4 37 47 20 20

| | |
|------------------------------|----------------------|
| Type | <input type="text"/> |
| N° de série Serial number | <input type="text"/> |
| Année Year | <input type="text"/> |
| Masse totale Weight | <input type="text"/> |
| Puissance Power | <input type="text"/> |

This Equipment complies to the current European regulations and is delivered with its CE Certificate and Compliance Plate.