

EURO-SEEDER T400 CE



EURO-SEEDER T400
CE

PRODUCT DESCRIPTION
FINN - the inventor of the Hydroseeder - is the world leader for over 80 years now in manufacturing these specialized machines that provide those Business Professionals anxious to intervene in the hydroseeding and hydromulching sector with power, efficiency and professionalism with the right equipment.

In order to choose the machine that's right for you and to learn more about this fascinating business, please visit the 'European Hydroseeding Guide' (currently only available in French) on our site www.euro-tec.fr.

SPECIFICATIONS & PERFORMANCE

Tank Capacity	15 000 litre
Engine	John DEERE 4045T Turbo Diesel Tier III, 125 HP
Mixing system	Double Agitator, Mechanical Agitation with paddles, hydraulically powered, reversible, variable speed
Pump	FINN Centrifugal pump, 5" x 2 ½" (12.7 cm x 6.4 cm), 400 GPM@130 psi (1 514 lpm @ 896 kPa), adjustable
Weight	4 750 Kg empty / 20 000 Kg loaded
Dimensions	722 cm length, 231 cm width, 247 cm height
Available Options	<ul style="list-style-type: none"> - Hydraulic hose reel with 60 lm 1 ¼" hose mounted on 3 Position Pivoting Cradle - Extra set of Ground Level Controls - Volumetric pump (in addition to centrifugal pump) - RAL paint to match your company colour
Spraying Distance	70 metres from canon
Tank empty time	11 minutes with the canon
Mixing capacity	5 600 Kg granular (fertilizer) / 800 Kg Fibre Material (Mulch)
Daily Production Capacity	80 000 m ² Hydroseeding / 18 500 m ² Hydromulching

TECHNICAL ASSISTANCE / AFTER SALES SERVICE





9281 LeSaint Drive • Fairfield, Ohio 45014
Phone (513) 874-2919 • Fax (513) 874-2914
Parts Dept.: 1-800-323-8707
Sales: 1-800-543-7195

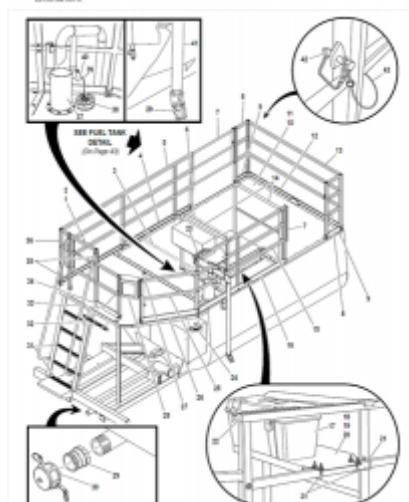

T280/330 HydroSeeder®
Parts and Operator's Manual

Model **SM** Serial No. _____





The User Manual with its exploded machine and parts view allows for optimum and quick reaction whenever needed, making use of an important spare part stock FINN Europe based in the Lyon (France) area. A technician on the hot-line can thus identify the issue, send spare parts or decide on eventual on-site support and repair.

CE COMPLIANCE

This Equipment complies to the current European regulations and is delivered with its CE Certificate and Compliance Plate.